

Product Dimensions And Specifications

Spouting
Elbows / Clamps
Spouting Accessories
Flanges
Square Spout
Transitions
R and P Slide Gates
Cushion Boxes
LCDM Deadbox
Valves
Flow Retarder/ Overflow
Round Branches
Stainless Steel
Product Specs

Round Cushion Box (DBAC)

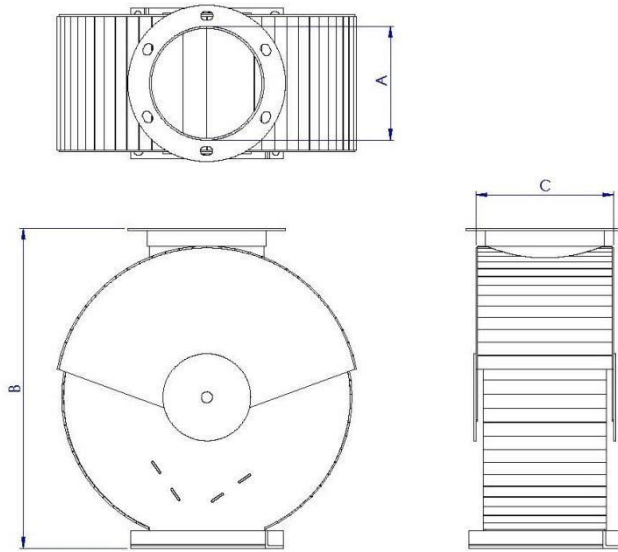

Size (A)	B	C
6"	20 5/8"	7 3/8"
8"	22 3/8"	9 3/8"
10"	26"	11 3/8"
12"	30 7/8"	13 3/8"
14"	31"	15 3/8"
16"	38 3/4"	17 3/8"

Pipe Deadbox (45°) (DBFP)

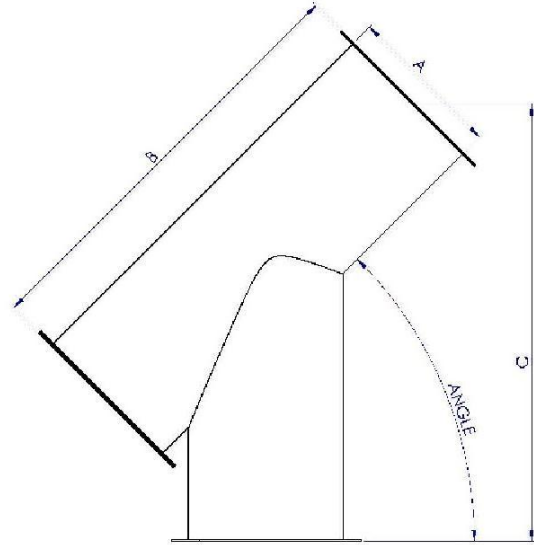

Size (A)	B	C
6"	18.4"	19"
8"	23.3"	24.3"
10"	28.5"	29.5"
12"	33.7"	35.2"
14"	38.7"	40.4"

Box Style Deadbox (45°) (DBFB90)

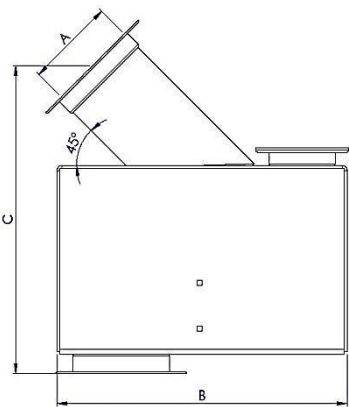

Size (A)	B	C
6"	18 11/16"	20 11/16"
8"	24 5/16"	26 3/16"
10"	30"	31 13/16"
12"	35 11/16"	35 5/16"
14"	41 3/8"	38 7/8"

Box Style Deadbox (90°) (DBFB45)

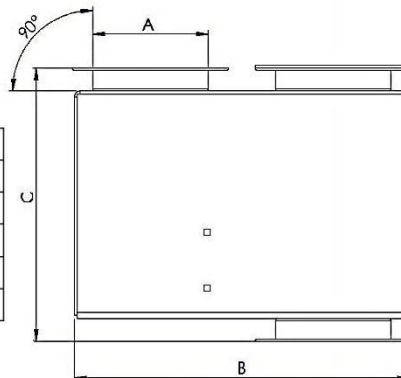

Size (A)	B	C
6"	18"	16"
8"	22"	20"
10"	26"	24"
12"	30"	26"
14"	34"	28"

Inline Flow Retarder (FRIS)

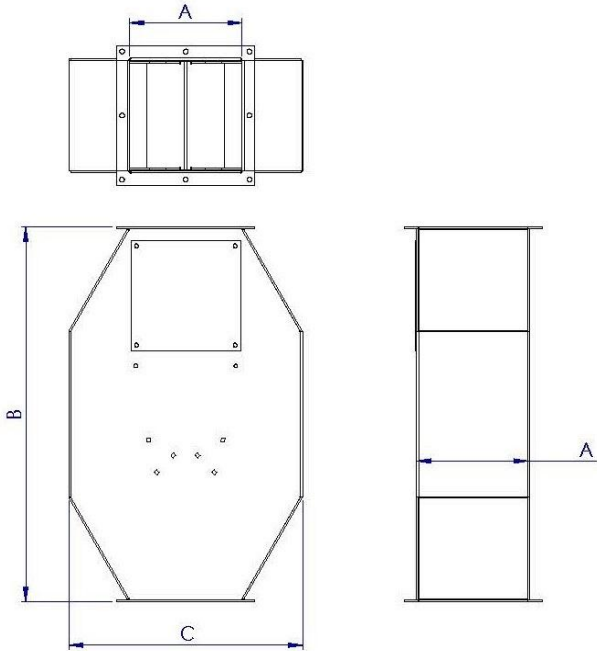

Size (A)	B	C
6"	26"	13"
8"	32"	17"
10"	34"	21"
12"	37"	25"
14"	40 1/2"	29"

Overflow Valve (OVFS)

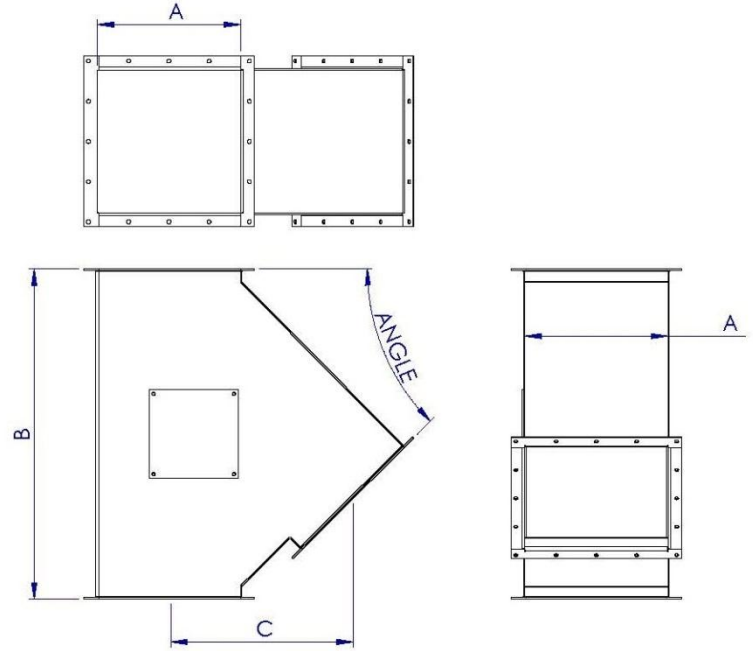

Size (A)	B	C
6"	22 1/2"	15"
8"	25 1/2"	17 7/8"
10"	28 1/4"	20 5/8"
12"	31"	23 1/4"
14"	34"	25 7/8"

Rack and Pinion Slide Gates (GTRS)

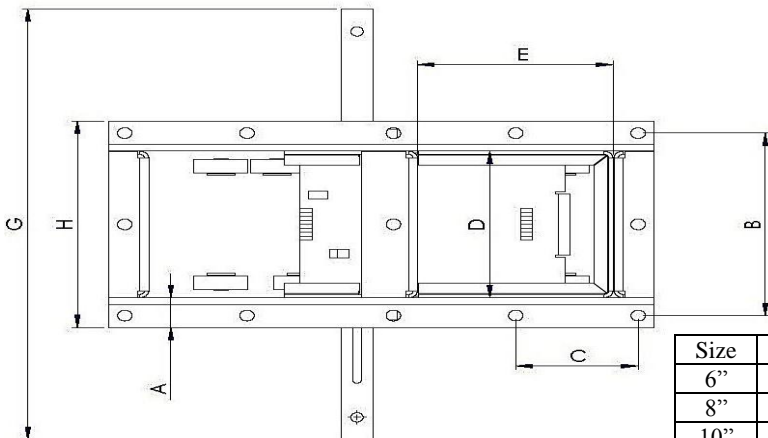

Size	A	B	C	D/E	Length	G	H
6"	1 1/4"	7 5/8"	3 13/16"	6 1/8"	17"	18"	8 5/8"
8"	1 1/4"	9 5/8"	4 13/16"	8 1/8"	21"	20"	10 5/8"
10"	1 1/4"	11 5/8"	5 13/16"	10 1/8"	25"	22"	12 5/8"
12"	1 1/2"	14"	4 21/32"	12 1/8"	29 1/2"	24"	15 1/8"
14"	1 1/2"	16"	4"	14 1/8"	33 1/2"	26"	17 1/8"
16"	1 1/2"	18"	4 1/2"	16 1/8"	37 1/2"	28"	19 1/8"
18"	1 1/2"	20"	5"	18 1/8"	41 1/2"	30"	21 1/8"
20"	1 1/2"	22"	5 1/2"	20 1/8"	45 1/2"	32"	23 1/8"
24"	1 1/2"	26"	4 21/64"	24 1/8"	53 1/2"	36"	27 1/8"

***All Gates are 5 1/2" tall**

45° K-Type Pan Valve (VAKS)

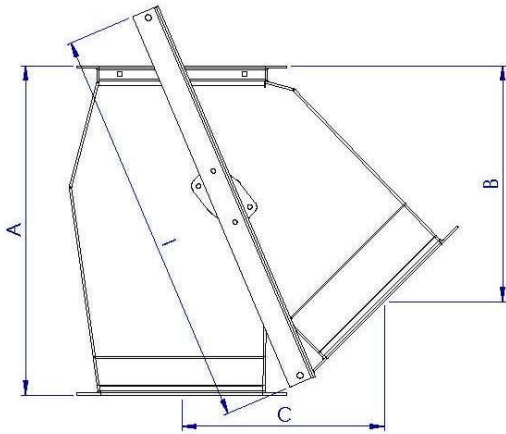

Size	A	B	C
6"	13"	9 3/8"	8 1/8"
8"	16"	11 3/8"	9 3/4"
10"	19 7/8"	14 1/4"	12 1/4"
12"	23 3/4"	17"	14 5/8"
14"	27 3/4"	19 3/4"	17"

45° Y-Type Pan Valve (VAYS)

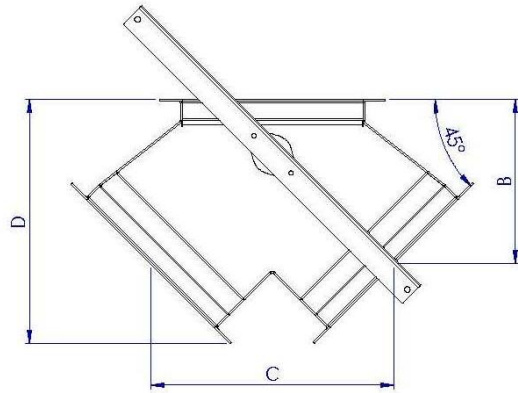

Size (A)	B	C	D
6"	7"	10"	10"
8"	7 5/8"	11 7/8"	11 3/8"
10"	9 5/8"	15 1/2"	14"
12"	11 1/4"	16 1/2"	16 3/5"
14"	12 1/4"	18 1/2"	18 5/9"

Three-Way Valve (VATS)

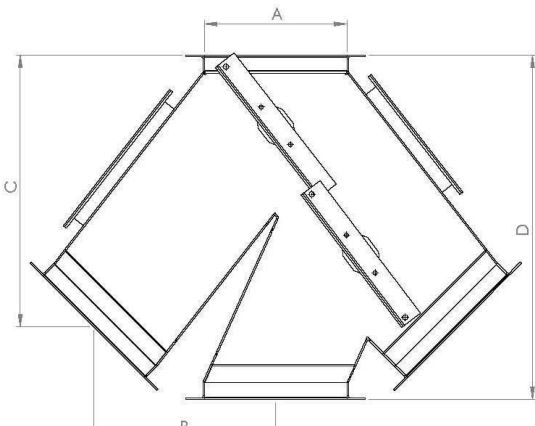

Size	A	B	C
6"	6"	8 1/8"	12 1/4"
8"	8"	13 1/8"	18 1/4"
10"	10"	17 1/4"	23"
12"	12"	15 5/8"	23 1/4"
14"	14"	16 1/2"	24 7/8"
16"	16"	21"	31 1/4"

Damper Style Valve (VAKSD)

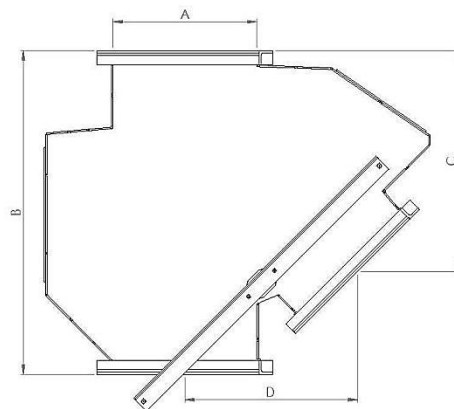

Size	A	B	C	Size	A	B	C
6"	6"	15 3/8"	11 1/4"	18"	18"	39 3/8"	28"
8"	8"	19 1/2"	14 1/2"	20"	20"	43 1/8"	31"
10"	10"	23"	16 1/2"	22"	22"	46 3/4"	33 3/4"
12"	12"	26 3/4"	19 1/2"	24"	24"	50"	34 3/4"
14"	14"	31 1/8"	20"	30"	30"	61 3/8"	43 3/8"
16"	16"	35 1/4"	24 1/2"				

Square to Round (TRSR) and Square to Square (TRSS) Transitions

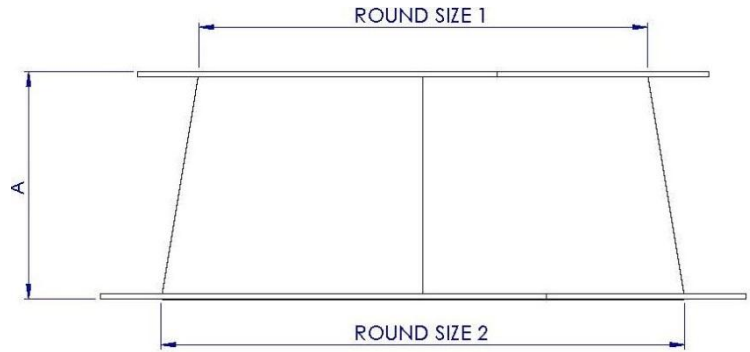
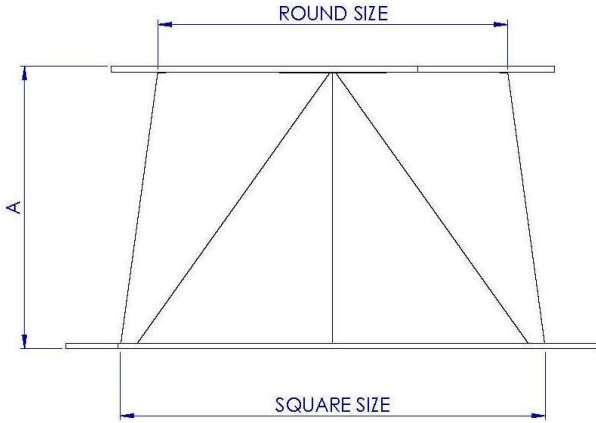

Square	Round	Height
6"	6"	5 1/4"
8"	6"	6 3/4"
8"	8"	5 1/4"
10"	8"	6 3/4"
10"	10"	5 1/4"
12"	10"	8"
12"	12"	6 1/4"
14"	10"	10"
14"	12"	10"
14"	14"	6 1/4"
16"	10"	10"
16"	12"	10"
16"	14"	10"
16"	16"	10"
18"	14"	10"
18"	16"	10"
18"	18"	10"
20"	16"	10"
20"	18"	10"
20"	20"	10"
24"	20"	10"
24"	22"	10"
24"	24"	10"

Round to Round Reducers

- 2" Reduction Reducers are 6" tall
- 4" Reduction Reducers are 12" tall
- 6" Reduction Reducers are 18" tall

*Square to Round and Square to Square Transitions have the same height.

LCDM Commercial Deadbox (DBAR)
Patent Pending

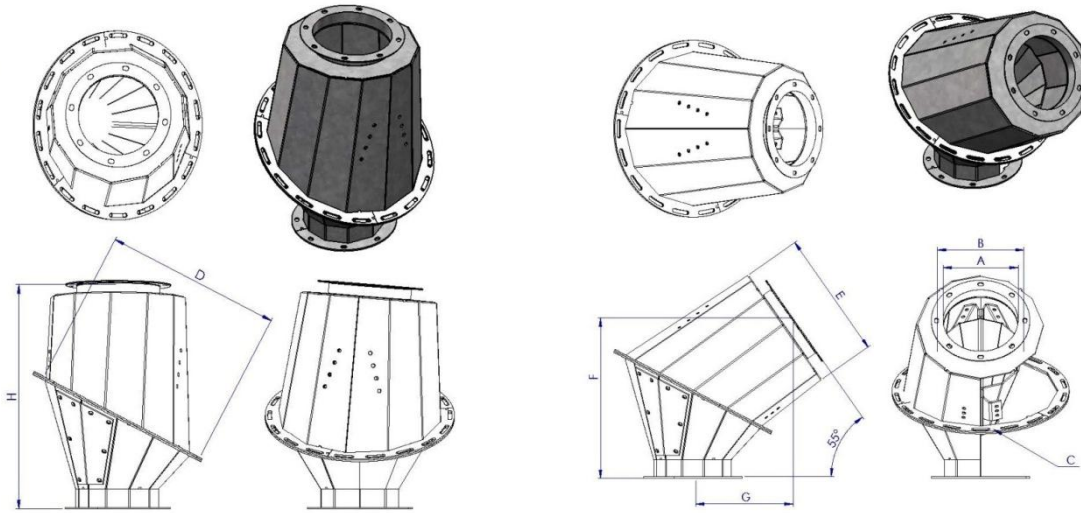

Size (A)	B	C	D	E	F	G	H
8"	9"	3"	16"	14"	17"	11"	28"
10"	11"	3"	20"	17"	21"	13"	27"
12"	13"	3"	24"	20"	24"	16"	33"
14"	15"	3"	28"	23"	28"	19"	38"
16"	17"	3"	32"	26"	32"	22"	43"
18"	19"	3"	36"	29"	34"	23"	48"
20"	21"	3"	40"	32"	38"	25"	53"

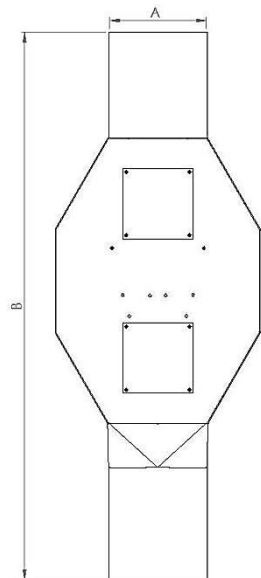

Flow Retarder with Welding Sleeve (FRIR)

Size	A	B
6"	6"	62 3/8"
8"	8"	68 3/8"
10"	10"	70 3/8"
12"	12"	74 3/8"
14"	14"	78
16"	16"	91 1/8"

Angle Iron Rings (FLAR)

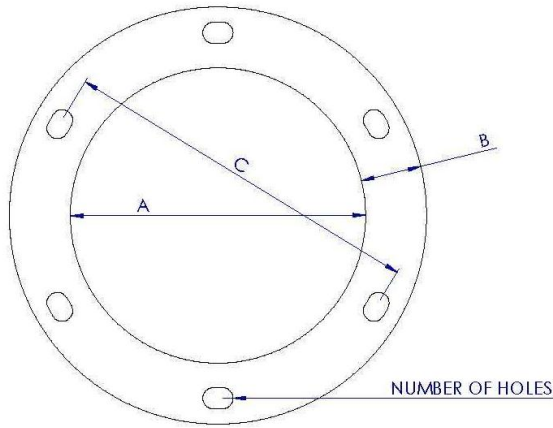

Adjustable Elbow (ELTE)

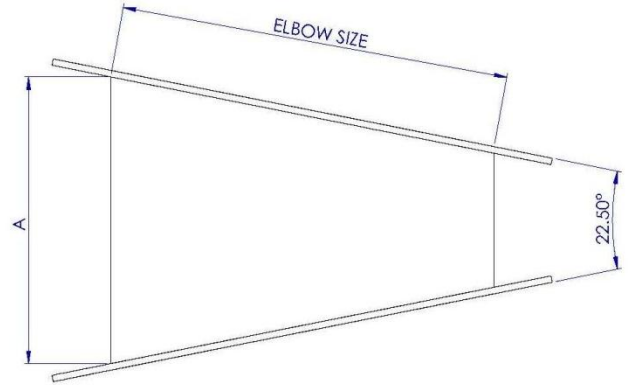

Size	A	B	C	# of holes	Weight
6"	6 1/16"	1 1/4"	7 1/2"	6	1.8
8"	8 1/16"	1 1/4"	9 1/2"	8	2.3
10"	10 1/16"	1 1/4"	11 1/2"	8	2.8
12"	12 1/8"	1 1/2"	13 13/16"	12	6
14"	14 1/8"	1 1/2"	15 13/16"	12	7
16"	16 1/8"	1 1/2"	18 1/8"	16	8
18"	18 1/8"	1 1/2"	20 1/8"	16	8.5
20"	20 1/8"	1 1/2"	22 1/8"	20	9.5
22"	22 3/8"	1 1/2"	24 1/8"	20	10.8
24"	24 3/8"	1 1/2"	26 1/8"	20	11.5

Size	A
6"	5"
8"	6"
10"	7"
12"	8"
14"	9"
16"	10"

Angle Iron Flange (FLAS)

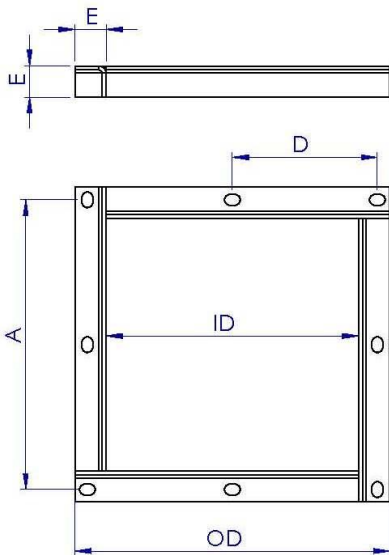

Size	A	O.D	I.D	D	E
6"	7 5/8"	8 5/8"	6 1/8"	3 13/16"	1 1/4"
8"	9 5/8"	10 5/8"	8 1/8"	4 13/16"	1 1/4"
10"	11 5/8"	12 5/8"	10 1/8"	5 13/16"	1 1/4"
12"	14"	15 1/8"	12 1/8"	4 21/32"	1 1/2"
14"	16"	17 1/8"	14 1/8"	4"	1 1/2"
16"	18"	19 1/8"	16 1/8"	4 1/2"	1 1/2"
18"	20"	21 1/8"	18 1/8"	5"	1 1/2"
20"	22"	23 1/8"	20 1/8"	5 1/2"	1 1/2"
22"	24"	25 1/8"	22 1/8"	4"	1 1/2"
24"	26"	27 1/8"	24 1/8"	4 21/64"	1 1/2"

Branch (Offset) BRPK

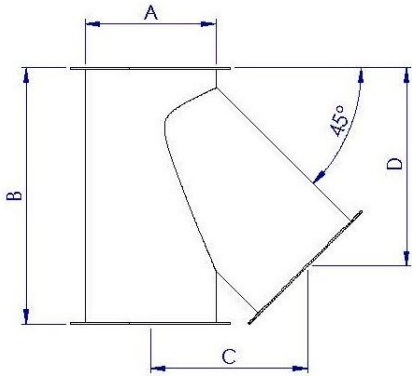

Size (A)	B	C	D
6"	16"	9"	17"
8"	18"	11"	19"
10"	21"	13"	17"
12"	25"	15"	19"
14"	28"	17"	22"

Branch (3-Way) BRPT

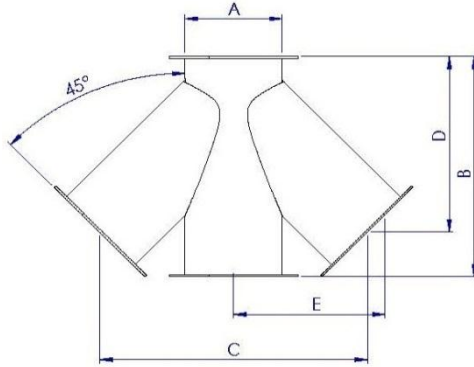

Size (A)	B	C	D	E
6"	16"	19"	13"	9"
8"	18"	22"	15"	11"
10"	21"	25"	17"	13"
12"	25"	30"	19"	15"
14"	28"	33"	22"	16"

Branch (2-Way) BRPY

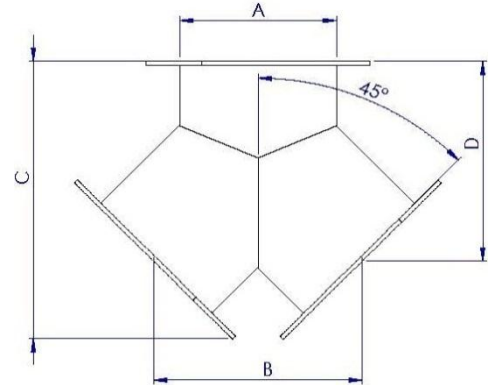

Size (A)	B	C	D	E
6"	16"	19"	13"	9"
8"	18"	22"	15"	11"
10"	21"	25"	17"	13"
12"	25"	30"	19"	15"
14"	28"	33"	22"	16"

Square Wedges (45° and 10°) (WGFS)

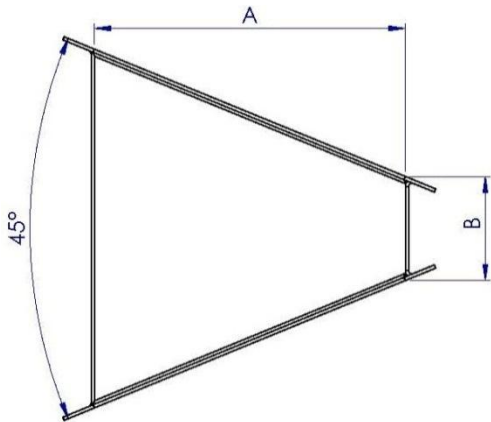

Size (A)	B
6"	4"
8"	4"
10"	4"
12"	5"
14"	5"
16"	5"

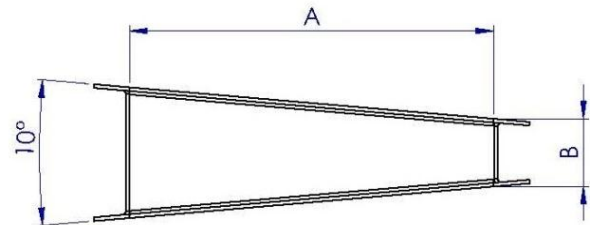

Size (A)	B
6"	2.5"
8"	2.5"
10"	2.5"
12"	3"
14"	3"
16"	3"